

CG CITY
Phase-II

Developed By
SKA BUILDCON

8962335962
9301346709

A RIGHT CHOICE FOR YOUR BIG DREAMS

आज ही रहने योग्य NACP एवं RERA Approved Project



Spacious 3 BHK Row-House Along With Quality Construction

CG CITY

Phase-II
Layout Map



60+ खुशहाल परिवार निवासरत ...!

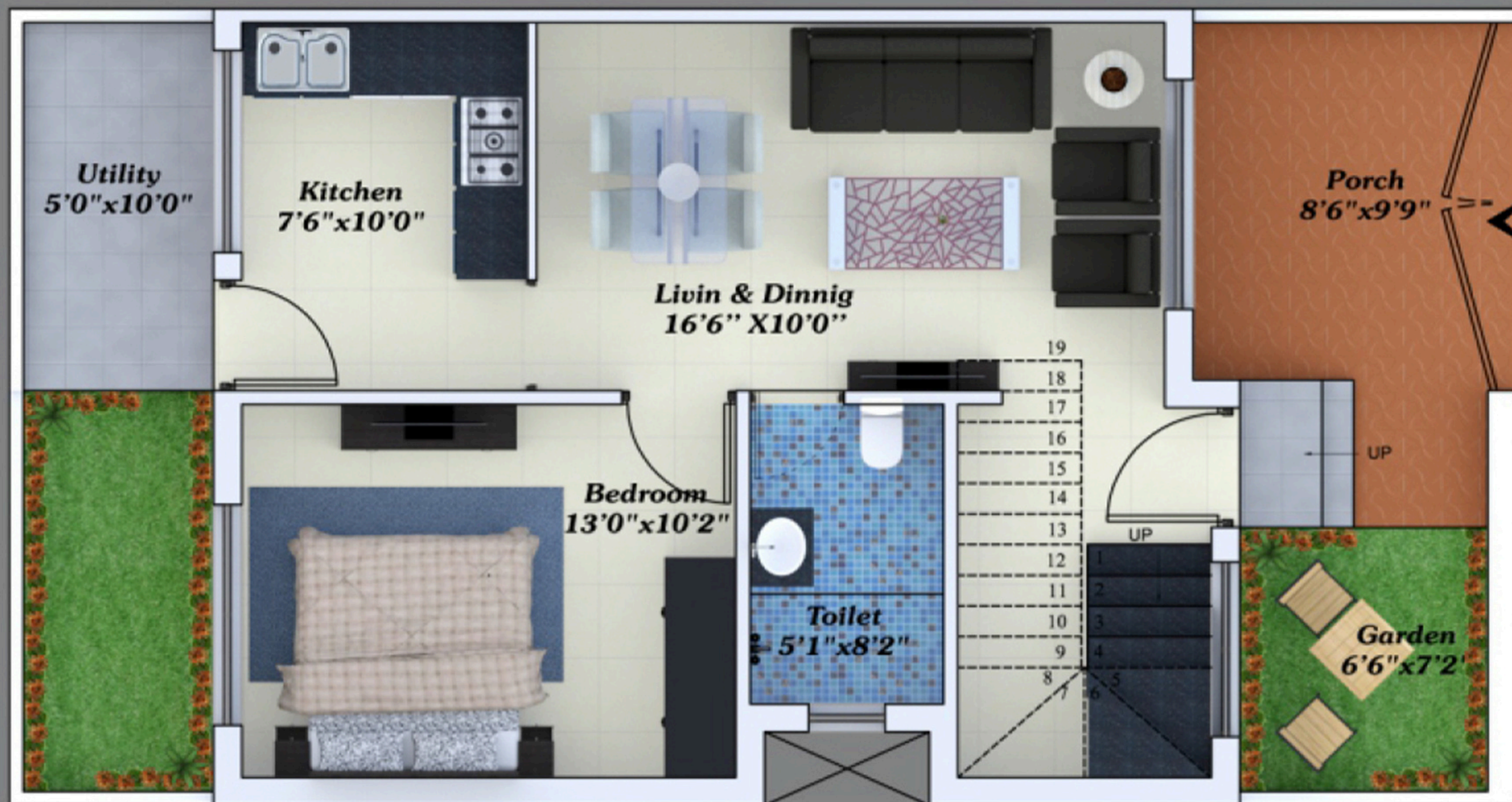

GROUND FLOOR

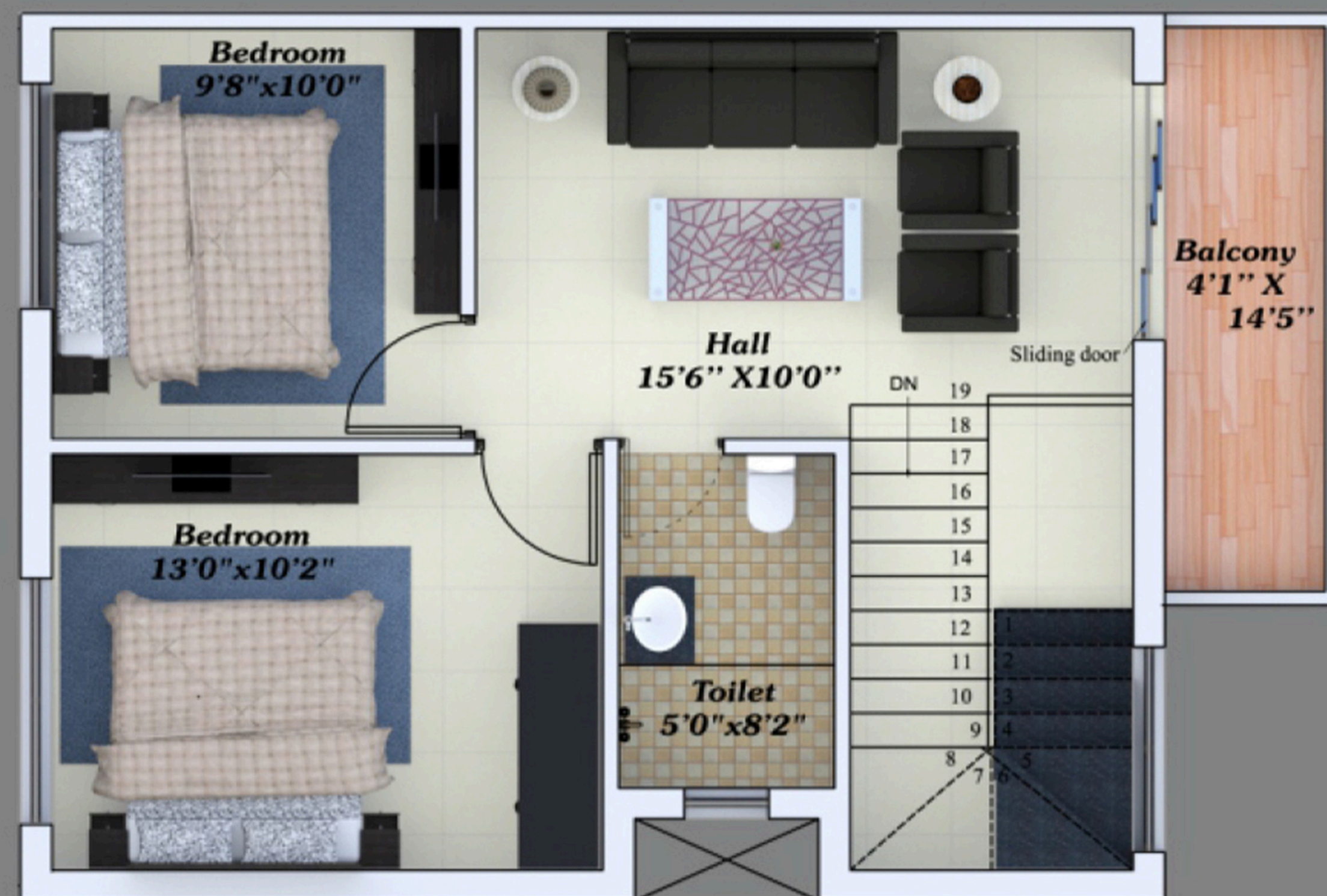

FIRST FLOOR



First Floor



Ground Floor

Plot No.56-59

Plot Size	- 857.67 sqft
Ground Floor	- 530.75 sqft
First Floor	- 606.57 sqft
Buildup Area	- 1137 sqft
Porch Area	- 57.90 sqft

80 to 90% Bank Loan Facility Available Form All Mejur Bank In India



3 BHK Rowhouse Near Umda Greens

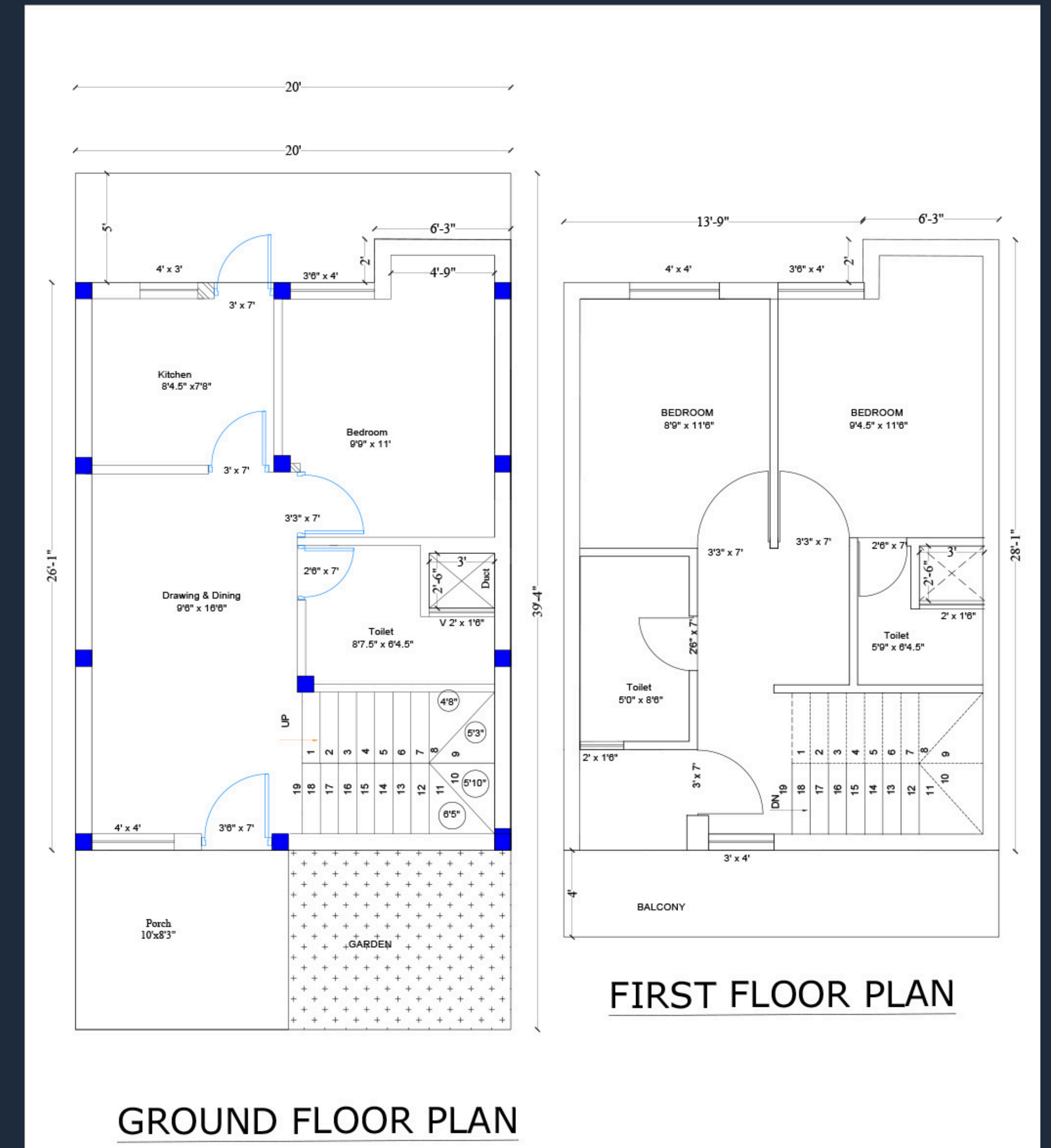

Just Rs. 28.50 Lac's

80 to 90% Bank Loan Facility Available Form All Mejor Bank In India

Facility & Highlight In C.G. City



Main Entrance Gate



24 X 7 Security



C.C. T.V. Surveillance



Wide Road



Underground Drainage & Sewerage



Garden & Play Area



Water Harvesting

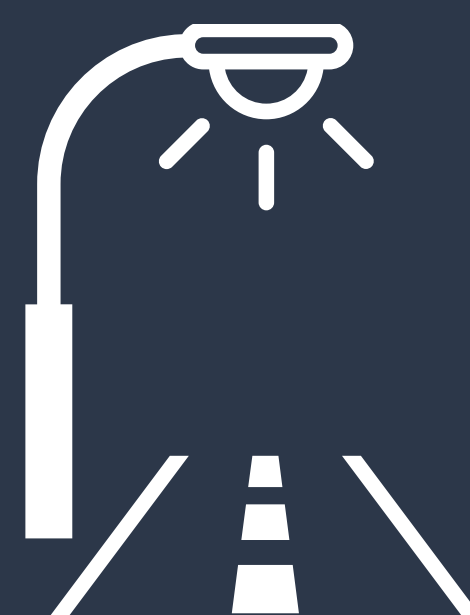

Street Light

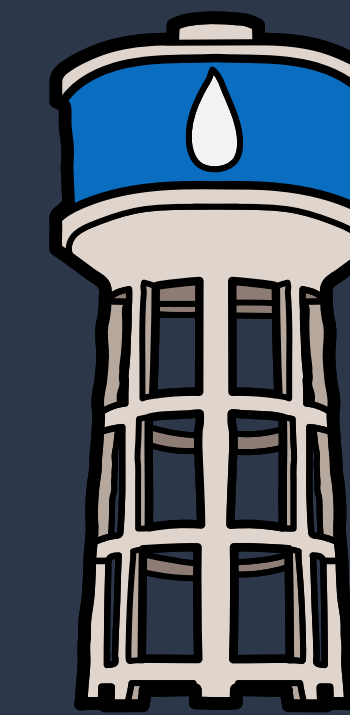

Over Head Water Tank



Jogging Track

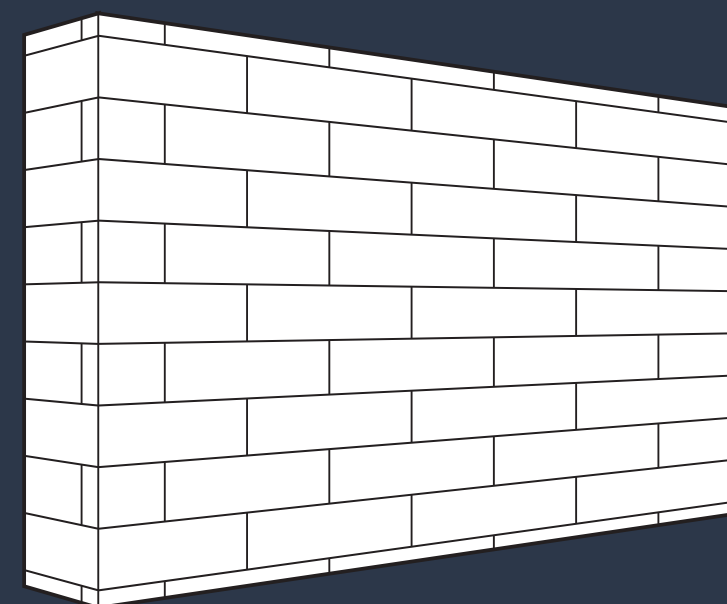

Boundary Wall

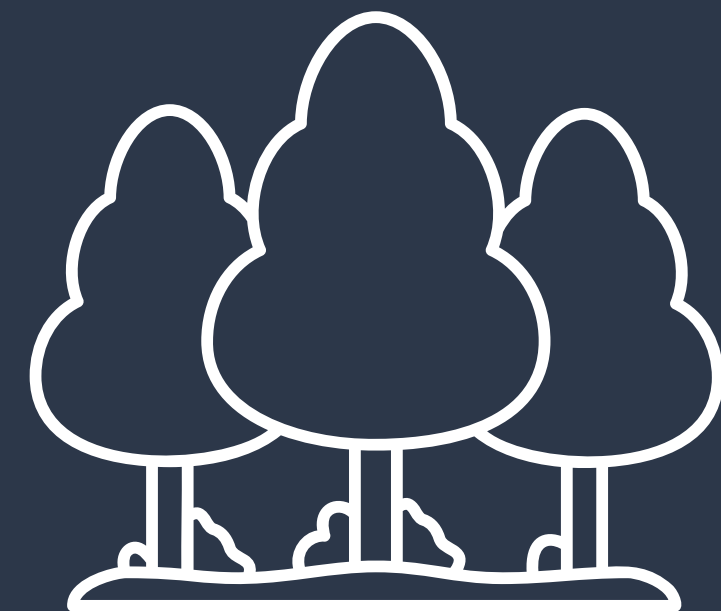

Lush Green Area

and many more ..!



दुर्ग रायपुर हाईवे से मात्र 10 मिनट की दूरी पर - हॉस्पिटल , बाज़ार, स्कूल , बैंक 1 से 1.5 km. की दूरी पर

- 1. STRUCTURE - R.C.C. framed structure.
- 2. DOORS - Entrance doors - Flushed & sal wood framed.
Internal doors - Laminated, flushed & sal wood framed.
Toilet door - P.V.C. or laminated flush door.
- 3. windows - Powder coated aluminium window glass panels and provision of insect nets and M.S. grills.
- 4. FLOORS - Vitrified tiles in interior. Anti skid ceramic tiles on balconies & terraces. Checkerred tiles on carporch, drive way and rear washing area.
- 5. TOILETS - Anti skid ceramic floor tiles. Designer tiles on walls upto door height. Proper water proofing. sanitary ware and W.C. in one toilet and E.W.C. in other toilet with cistern. Provision of hot and cold water pipe lines in toilet.
- 6. KITCHEN - Granite counter top with S.S. Sink. Ceramic tiles upto 2'0" above Kitchen platform. Provision of exhaustfan.
- 7. FINISH - All internal walls to be finished with two coats of putty and plastic emulsion paint.
- 8. ELECTRICAL - Concealed conduit copper wiring with adequate points for fans, lights, aircoolers, T.V., geyser, exhaust etc. Cable connection in drawing and master bedroom. Modular fittings.
- 9. PLUMBING - Concealed C.P.V.C. pipes with C.P. fittings.
- 10. SEWAGE DISPOSAL - Individual septic tank.
- 11. WATER SUPPLY - 500 lt P.V.C. over head tank.

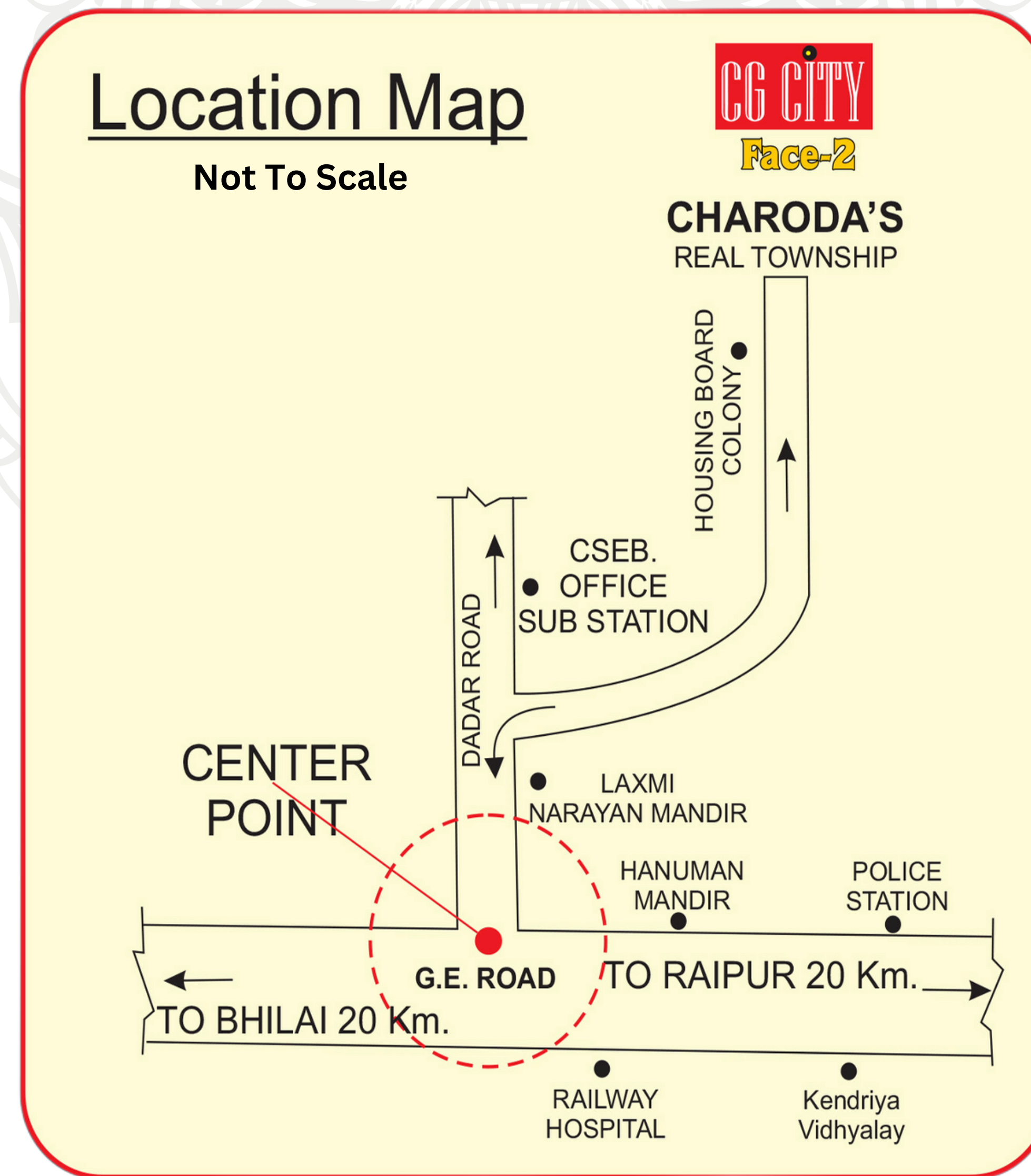

:: Office Address ::

SKA Buildcon G.E. Road Charoda Chhattisgarh

8962335962/ 9586955212